



Single Hydraulic Parker Denison Vane Pump

T6C T6D T6E T7E

Features

- T6C, T6D T6E and T7E Series are fixed displacement and balanced type single hydraulic vane pumps. The pump is designed for higher operating pressure and greater flow at the same housing size.
- With a balanced pin-vane design, outlet pressure is continuously applied only to the pin. The pin provides the steady light force against the vane. Top and bottom areas of the vane are subject to the same pressure, either inlet or outlet pressure, depending on the vane's location during rotor rotation. This pin-vane design minimizes noise level and improves volumetric efficiency.
- With the cartridge independent of the shaft, allowing for easy change of flow capacity and field servicing without removing the pump from its mounting.



Ordering Code

T6C - 022 - 1R00 - B1

Model T6C, T6D, T6E

Ring Size (US gallon)

T6C – 003, 005, 006, 008, 010, 012, 014, 015, 017, 020, 022, 025, 028, 031
T6D- 014, 017, 020, 024, 028, 031, 035, 038, 042, 045, 050, 061

Shaft type

1 - Keyed (SAE B/ SAEC/ SAE CC)
2 - Keyed (no SAE)
3 - Splined (SAE B/ SAE C)
4 - Splined (no SAE/ SAE BB/ SAE CC)
T- Splined (SAE J718c)

Shaft Rotation

(Viewed from shaft end)
R - Turn right
L - Turn left

Seal

1=S1 (for mineral oil)
4=S4 (for the resistant fluids)
5=S5 (for mineral oil and fire resistant fluids)

Design

Subject to change

Inlet Port position

(Viewed from cover end)
00 - Opposite Outlet (standard)
02 - 90° CCW from Outlet
01 - Inline with Outlet
03 - 90° CW from Outlet

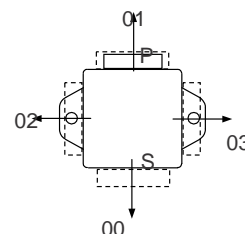



T6C SINGLE VANE PUMP

SERVICE PARTS INFORMATION

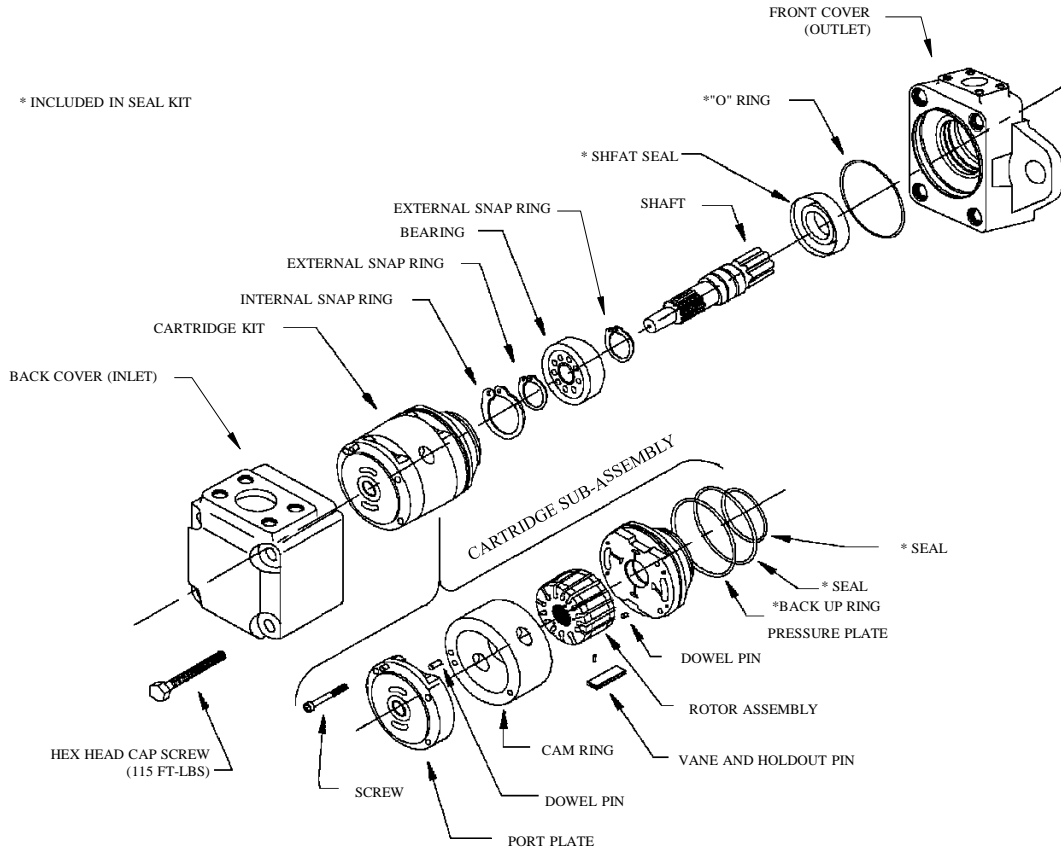

CARTRIDGE CHART

PUMP SIZE	CART. KIT	CAM RING	VANE KIT	ROTOR	PRESSURE PLATE	PORT PLATE	SHAFTS
T6C-003	S24-10692N	034-59050N	034-59099N	S24-10350N	034-59772N	034-59774N	#1 034-70814N
T6C-005	S24-10694N	034-59051N					#2 034-70880N
T6C-006	S24-10696N	034-59052N					#3 034-70815N
T6C-008	S24-10698N	034-59053N					#4 034-59426N
T6C-010	S24-10721N	034-59054N					
T6C-012	S24-26478N	034-66595N					
T6C-014	S24-10723N	034-59206N					
T6C-017	S24-10725N	034-59207N					
T6C-020	S24-26859N	034-66607N					
T6C-022	S24-10727N	034-59208N					
T6C-025	S24-10729N	034-59209N					
T6C-028	S24-97761N	034-59245N					
T6C-031	S24-45785N	034-66843N					

- All cartridge assemblies are factory tested prior to shipping -

STANDARD SEAL KIT	VITON SEAL KIT	STANDARD SHAFT SEAL	VITON SHAFT SEAL	BEARING	FRONT COVER	BACK COVER
S24-10333-0-N	S24-10333-5-N	620-82012N		230-82054N	034-48565N	034-48564N

Filtration :

For satisfactory service life, use full flow filtration to provide fluid which meets ISO cleanliness code 16/13 or better.

Installation Dimensions mm (inch)

T6D

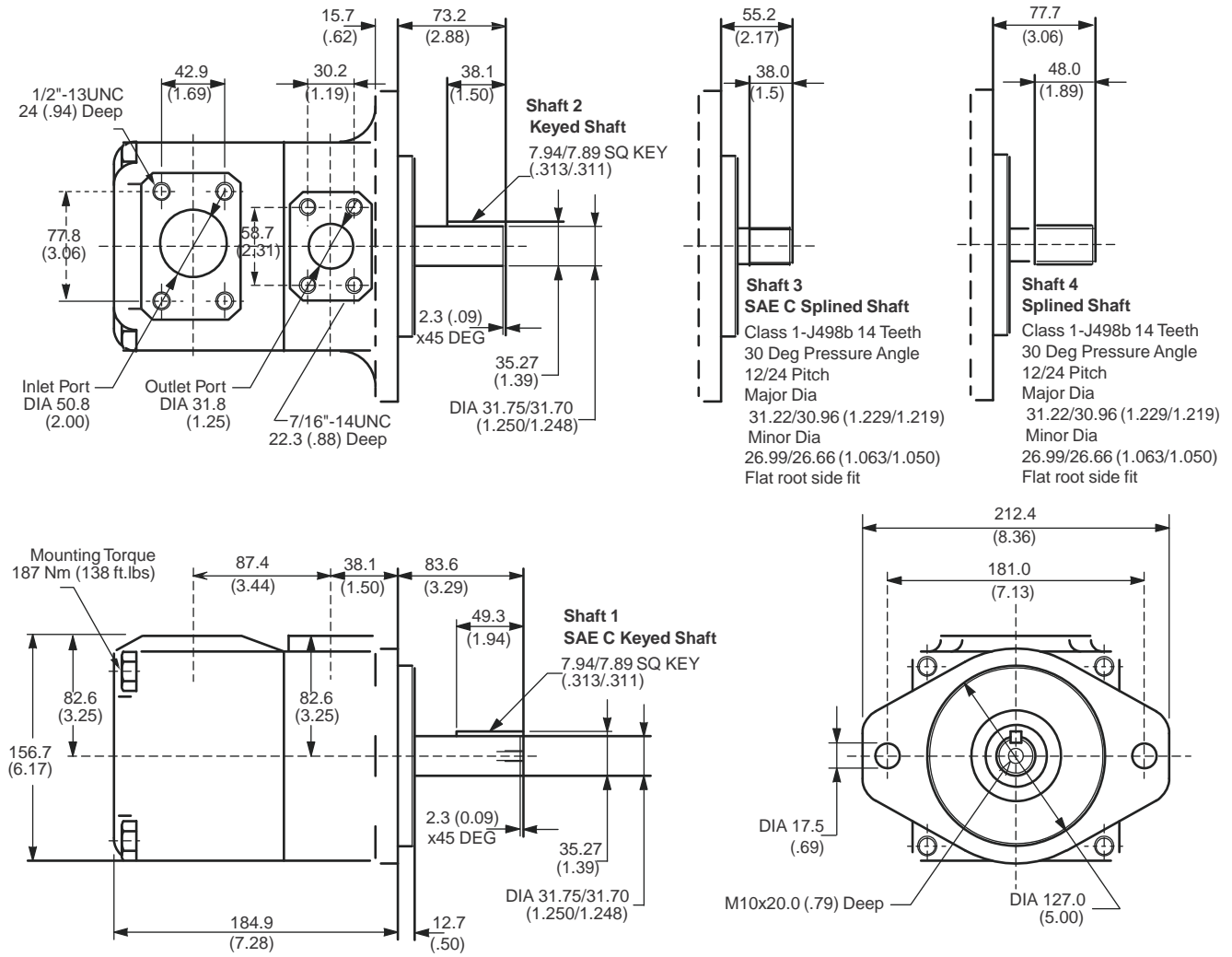

Specifications

T6D

Size	Displacement	Max Speed	Min Speed	Max Intermittent Pressure	Max Continuous Pressure	Weight
	cm ³ /r (in ³ /r)	rpm	rpm	bar (psi)	bar (psi)	kg (lb)
014	47.6 (2.90)					
020	66.0 (4.03)					
024	79.5 (4.85)					
028	89.7 (5.47)					
031	98.3 (6.00)	2500	600	240 (3500)	210 (3000)	
035	111.0 (6.77)					
038	120.3 (7.34)					24 (53)
042	136.0 (8.30)					
045	145.7 (8.89)	2200				
050	158.0 (9.64)			210 (3000)	160 (2320)	
061	190.5 (11.63)	1800		120 (1700)	80 (1160)	



T6D SINGLE VANE PUMP

SERVICE PARTS INFORMATION

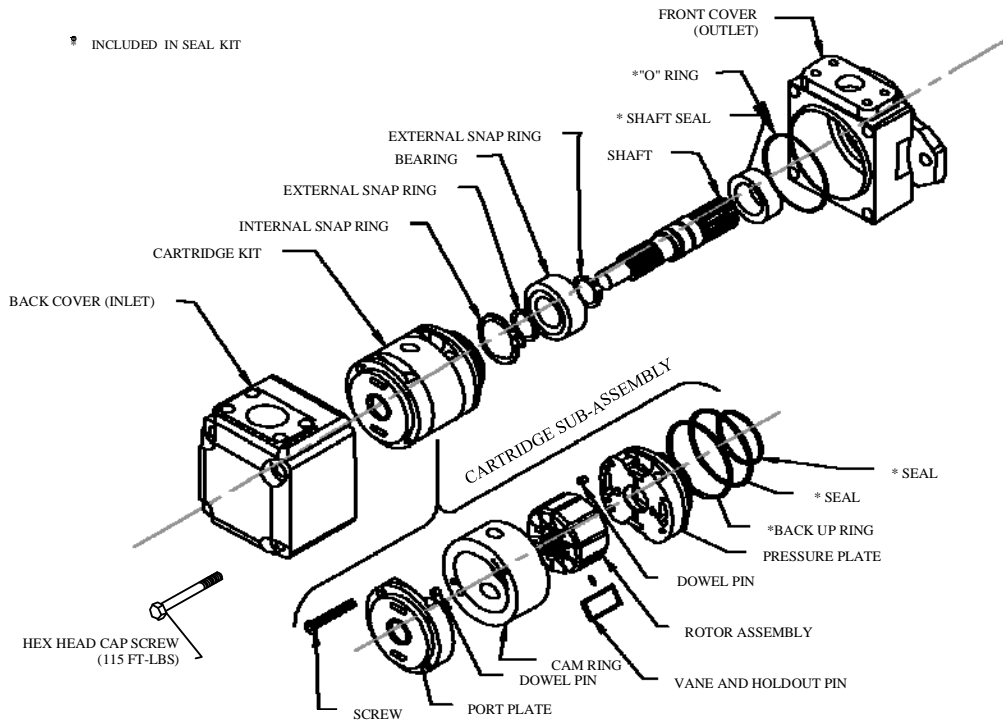

CARTRIDGE CHART

PUMP SIZE	CART. KIT	CAM RING	VANE KIT	ROTOR	PRESSURE PLATE	PORT PLATE	SHAFTS
T6D-014	S24-33849N	034-66708N	034-53588N	S24-10121N	034-59808N	034-59810N	#1 034-70858N
T6D-020	S24-26486N	034-66596N					#2 034-70980N
T6D-024	S24-97784N	034-59294N					#3 034-70859N
T6D-028	S24-10837N	034-59133N					
T6D-031	S24-10839N	034-59135N					
T6D-035	S24-10841N	034-59137N					
T6D-038	S24-10843N	034-59139N					
T6D-042	S24-10845N	034-59132N					
T6D-045	S24-10847N	034-59131N					
T6D-050	S24-40028N	034-66737N					

- All cartridge assemblies are factory tested prior to shipping -

STANDARD SEAL KIT	VITON SEAL KIT	STANDARD SHAFT SEAL	VITON SHAFT SEAL	BEARING	FRONT COVER	BACK COVER
S24-10138-0-N	S24-20047-5N	620-82062N	620-82066N	230-00207N	034-47916N	034-47917N

Filtration :

For satisfactory service life, use full flow filtration to provide fluid which meets ISO cleanliness code 16/13 or better.

Model No.

T6E/T7E - 072 - 1 R 00 - A 1 M0 - ..

T7E series - 125 A2 HW
 ISO 2 bolts 3019-2 mounting flange
T7ES series - SAE C 2 bolts
 Mounting flange J744

Displacement
 Volumetric displacement (in³/rev)

- 042 = 8.07
- 045 = 8.70
- 050 = 9.67
- 052 = 10.00
- 054 = 10.43
- 057 = 11.18
- 062 = 12.00
- 066 = 13.00
- 072 = 13.86

Type of shaft T7E - T7ES
 5 = keyed (ISO R775 - G38M)

Type of shaft T7ES
 1 = keyed (SAE CC)
 2 = keyed (non SAE)
 3 = splined (SAE C)
 4 = splined (SAE CC)

Modifications

Mounting w/connection variables
 4 bolts SAE flange (J518)

	Metric thread T7E - T7ES	UNC thread T7ES
	M0	00
P	1" 1/2	
S	3"	

Seal class
 1 = S1 - BUNA N
 4 = S4 - EPDM
 5 = S5 - VITON

Design letter

Porting combination
 00 = standard

Direction of rotation (view on shaft end)

- R = Clockwise
- L = Counter-clockwise

P = pressure port
 S = Suction port

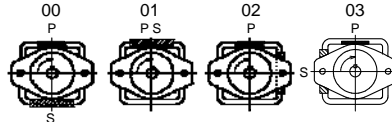

INTERNAL LEAKAGE (TYPICAL)

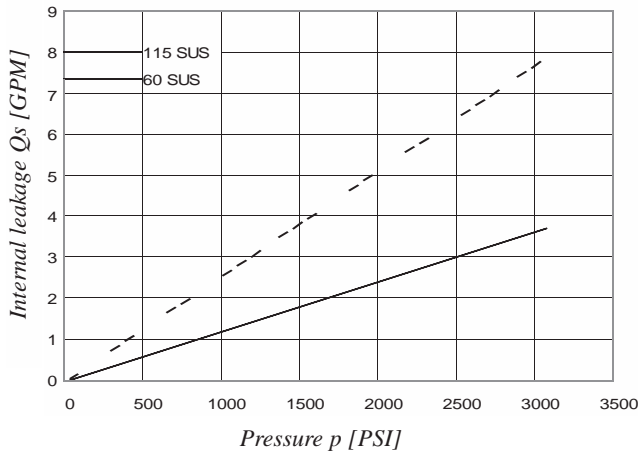

**NOISE LEVEL (TYPICAL)
 T7ES - 050**

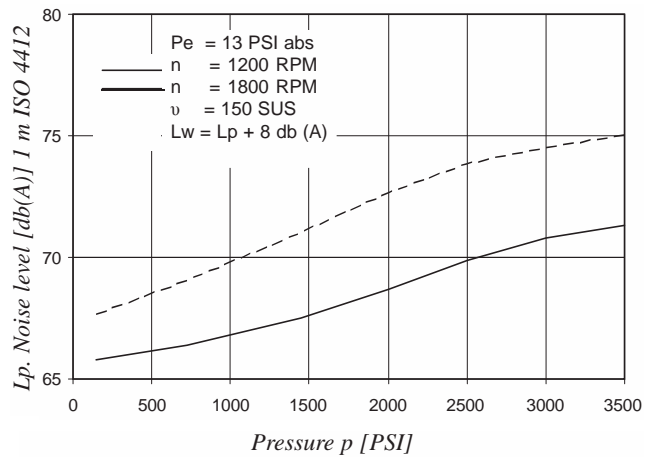

Do not operate pump more than 5 seconds at any speed or viscosity if internal leakage is more than 50% of theoretical flow.

HYDROMECHANICAL POWER LOSS (TYPICAL)

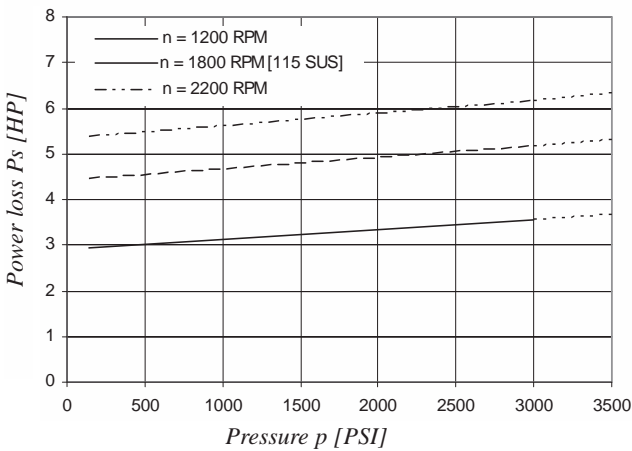

PERMISSIBLE RADIAL LOAD

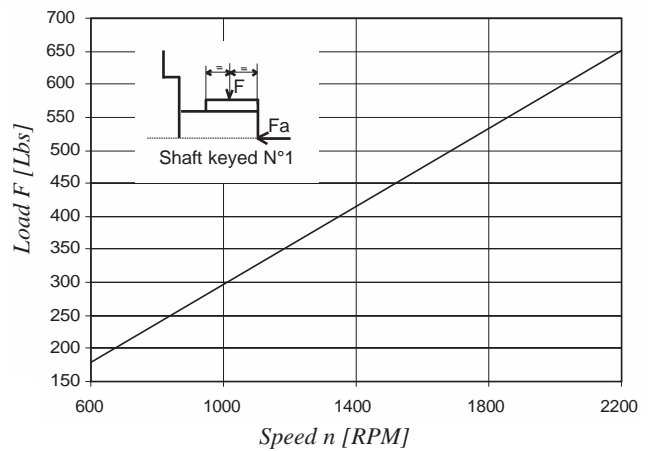

Maximum permissible axial load Fa = 449 Lbs

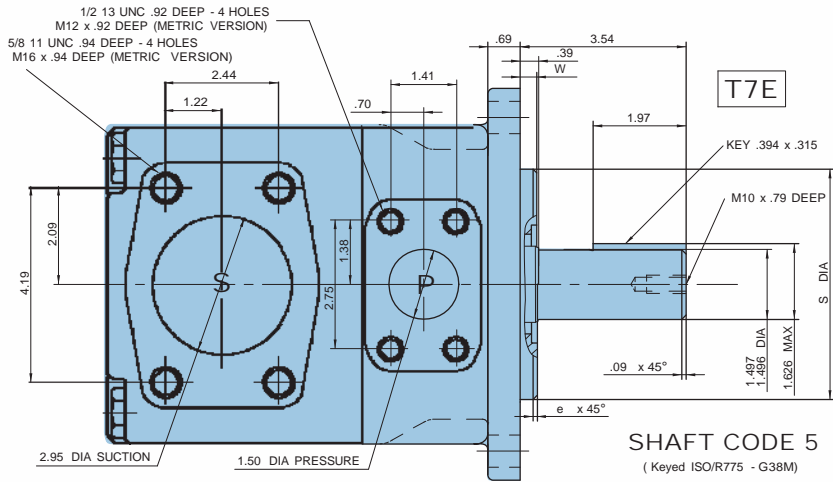

SHAFT CODE 5
(Keyed ISO/R775 - G38M)

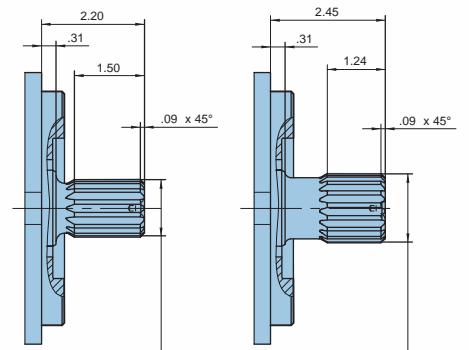

SHAFT CODE 3
SAE C INVOLUTE SPLINE DATA CLASS 1-FLAT ROOT SIDE FIT J498b - PITCH 12/24 14 TEETH - 30° PRESSURE ANGLE

SHAFT CODE 4
SAE CC INVOLUTE SPLINE DATA CLASS 1-FLAT ROOT SIDE FIT J498b - PITCH 12/24 17 TEETH - 30° PRESSURE ANGLE

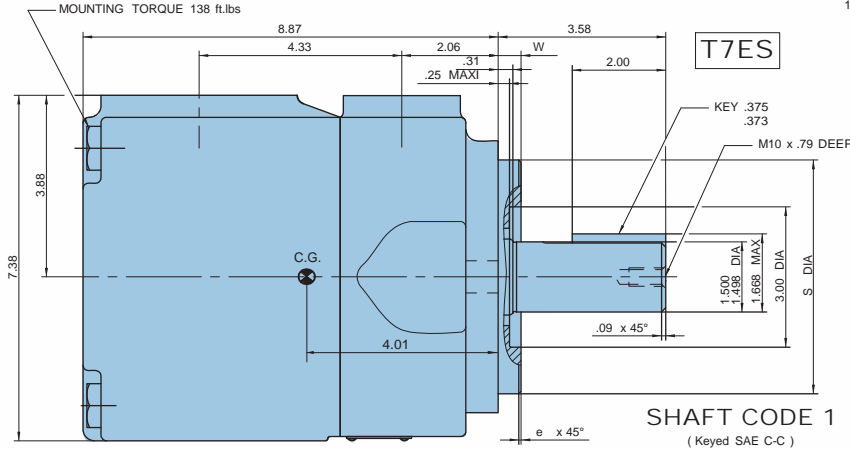

SHAFT CODE 1
(Keyed SAE C-C)

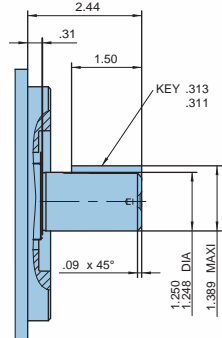
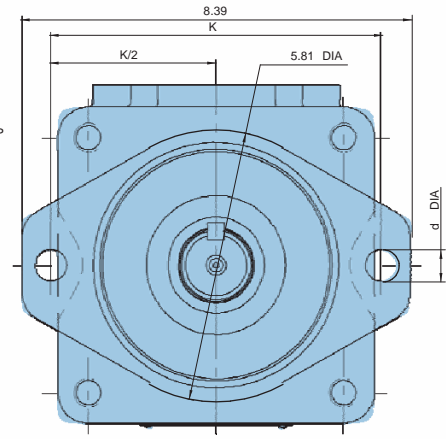

SHAFT CODE 2
(Keyed no SAE)

Shaft torque limits [in ³ /rev. x PSI]	
Shaft	Vi x p max.
1	48273
2	30638
3	54207
4	54207
5	48273

Alternate mounting flange						
Series	S DIA		e x 45°	W	K	d DIA
	Max.	Min.				
T7E	4.921	4.919	.079	.374	7.087	.709
T7ES	5.000	4.998	.051	.500	7.126	.689

OPERATING CHARACTERISTICS - TYPICAL [115 SUS]

Pressure port	Series	Volumetric Displacement Vi	Flow qVe [GPM] & n = 1800 RPM			Input power P [HP] & n = 1800 RPM		
			p = 0 PSI	P = 2000 PSI	P = 3500 PSI	p = 100 PSI	p = 2000 PSI	p = 3500 PSI
T6E T7E	042	8.07 in ³ /rev	62.92	60.37	58.52	8.09	78.44	133.80
	045	8.70 in ³ /rev	67.72	65.17	63.32	8.37	84.04	143.60
	050	9.67 in ³ /rev	75.38	72.83	70.98	8.82	92.97	159.24
	052	10.00 in ³ /rev	78.37	75.82	73.97	8.99	96.47	165.36
	054	10.43 in ³ /rev	81.27	78.72	76.87	9.17	99.75	177.46
	057	11.18 in ³ /rev	87.12	84.57	82.72	9.51	106.57	189.84
	062	12.00 in ³ /rev	93.54	90.99	89.14	9.88	114.17	196.34
	066	13.00 in ³ /rev	101.44	98.89	97.04	10.34	123.38	212.46
	072	13.86 in ³ /rev	108.00	105.45	103.60	10.72	131.04	225.86
	085	16.40 in ³ /rev	127.79	126.13 ¹⁾	-	11.88	101.66 ¹⁾	-

¹⁾ 085 = 1300 PSI max. int.
* special 3" 1/2 (3.5 dia) suction also available - Please contact DENISON Hydraulics



T6E, T7E series SINGLE VANE PUMP

SERVICE PARTS INFORMATION

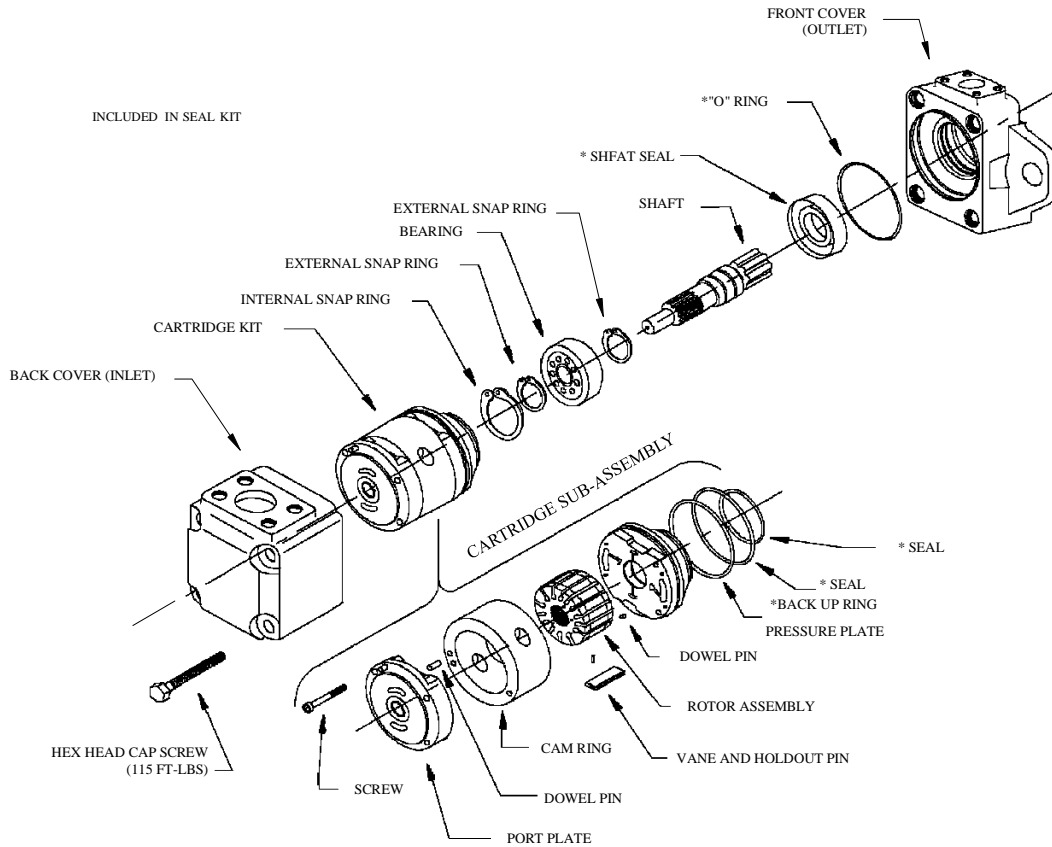

CARTRIDGE CHART

PUMP SIZE	CART. KIT	CAM RING	VANE KIT	ROTOR	PRESSURE PLATE	PORT PLATE	SHAFTS
T6E-045	S24-10177N	034-59164N	034-59162N	S24-10185N	034-59159N	034-59082N	#1 034-71076N
T6E-050	S24-40645N	034-66744N					#2 034-71078N
T6E-052	S24-10179N	034-59165N					#3 034-71077N
T6E-062	S24-10181N	034-59166N					
T6E-066	S24-10183N	034-59167N					
T6E-072	S24-40026N	034-66736N					

- All cartridge assemblies are factory tested prior to shipping -

STANDARD SEAL KIT	VITON SEAL KIT	STANDARD SHAFT SEAL	VITON SHAFT SEAL	BEARING	FRONT COVER	BACK COVER
S24-10186-0-N	S24-10186-5N	620-82064N	620-82064N	230-03208N	034-70249N	034-70247N

Filtration:

For satisfactory service life, use full flow filtration to provide fluid which meets ISO cleanliness code 16/13 or better.

OEM Part number	Denison vane pump
Parker Denison vane pump 024-03100-0	T6C0082R00B1
Parker Denison vane pump 024-03100-0/01	T6C0082R01B1
Parker Denison vane pump 024-03100-0/02	T6C0082R02B1
Parker Denison vane pump 024-03100-0/03	T6C0082R03B1
Parker Denison vane pump 024-03100-0/03	T6C0082R03B1
Parker Denison vane pump 024-03400-5/00	T6C0173R00B5
Parker Denison vane pump 024-03100-5	T6C0082R00B5
Parker Denison vane pump 024-03101-0	T6C0223R00B1
Parker Denison vane pump 024-03101-0/01	T6C0223R01B1
Parker Denison vane pump 024-03101-0/02	T6C0223R02B1
Parker Denison vane pump 024-03101-0/03	T6C0223R03B1
Parker Denison vane pump 024-03101-5	T6C0223R00B5
Parker Denison vane pump 024-03102-0	T6C0101R00B1
Parker Denison vane pump 024-03102-0/01	T6C0101R01B1
Parker Denison vane pump 024-03102-0/02	T6C0101R02B1
Parker Denison vane pump 024-03102-0/03	T6C0101R03B1
Parker Denison vane pump 024-03102-4	T6C0101R00B4
Parker Denison vane pump 024-03102-4/01	T6C0101R01B4
Parker Denison vane pump 024-03102-5	T6C0101R00B5
Parker Denison vane pump 024-03102-5/01	T6C0101R01B5
Parker Denison vane pump 024-03102-5/02	T6C0101R02B5
Parker Denison vane pump 024-03103-0	T6C0251R00B1
Parker Denison vane pump 024-03103-0	T6C0251R00B1
Parker Denison vane pump 024-03103-0/01	T6C0251R01B1
Parker Denison vane pump 024-03103-0/01	T6C0251R01B1
Parker Denison vane pump 024-03103-0/02	T6C0251R02B1
Parker Denison vane pump 024-03103-0/03	T6C0251R03B1
Parker Denison vane pump 024-03103-4	T6C0251R00B4
Parker Denison vane pump 024-03103-5	T6C0251R00B5
Parker Denison vane pump 024-03103-5	T6C0251R00B5
Parker Denison vane pump 024-03103-5/01	T6C0251R01B5
Parker Denison vane pump 024-03103-5/02	T6C0251R02B5
Parker Denison vane pump 024-03103-5/03	T6C0251R03B5
Parker Denison vane pump 024-03104-0	T6C0171R00B1
Parker Denison vane pump 024-03104-0	T6C0171R00B1
Parker Denison vane pump 024-03104-0/01	T6C0171R01B1
Parker Denison vane pump 024-03104-0/02	T6C0171R02B1
Parker Denison vane pump 024-03104-0/03	T6C0171R03B1
Parker Denison vane pump 024-03104-0/03	T6C0171R03B1
Parker Denison vane pump 024-03104-4	T6C0171R00B4
Parker Denison vane pump 024-03104-4/01	T6C0171R01B4
Parker Denison vane pump 024-03104-4/03	T6C0171R03B4
Parker Denison vane pump 024-03104-5	T6C0171R00B5
Parker Denison vane pump 024-03104-5/01	T6C0171R01B5
Parker Denison vane pump 024-03104-5/02	T6C0171R02B5
Parker Denison vane pump 024-03104-5/03	T6C0171R03B5
Parker Denison vane pump 024-03105-0	T6C0141R00B1
Parker Denison vane pump 024-03105-0	T6C0141R00B1
Parker Denison vane pump 024-03105-0/01	T6C0141R01B1
Parker Denison vane pump 024-03105-0/02	T6C0141R02C1
Parker Denison vane pump 024-03105-0/02	T6C0141R02B1
Parker Denison vane pump 024-03105-0/03	T6C0141R03B1
Parker Denison vane pump 024-03105-4	T6C0141R00B4
Parker Denison vane pump 024-03105-4/01	T6C0141R01B4
Parker Denison vane pump 024-03105-4/02	T6C0141R02B4
Parker Denison vane pump 024-03105-4/03	T6C0141R03B4
Parker Denison vane pump 024-03105-5	T6C0141R00B5
Parker Denison vane pump 024-03105-5/01	T6C0141R01B5
Parker Denison vane pump 024-03105-5/02	T6C0141R02B5
Parker Denison vane pump 024-03105-5/03	T6C0141R03B5
Parker Denison vane pump 024-03106-0	T6C0081R00B1
Parker Denison vane pump 024-03106-0	T6C0081R00B1
Parker Denison vane pump 024-03106-0/01	T6C0081R01B1
Parker Denison vane pump 024-03106-0/02	T6C0081R02B1
Parker Denison vane pump 024-03106-0/03	T6C0081R03B1
Parker Denison vane pump 024-03106-4	T6C0081R00B4
Parker Denison vane pump 024-03106-4/01	T6C0081R01B4
Parker Denison vane pump 024-03106-5	T6C0081R00B5
Parker Denison vane pump 024-03106-5/01	T6C0081R01B5
Parker Denison vane pump 024-03106-5/02	T6C0081R02B5
Parker Denison vane pump 024-03106-5/03	T6C0081R03B5
Parker Denison vane pump 024-03107-0	T6C0061R00B1
Parker Denison vane pump 024-03107-0	T6C0061R00B1
Parker Denison vane pump 024-03107-0/02	T6C0061R02B1
Parker Denison vane pump 024-03107-0/03	T6C0061R03B1
Parker Denison vane pump 024-03107-4	T6C0061R00B4

Parker Denison vane pump 024-03107-5	T6C0061R00B5
Parker Denison vane pump 024-03107-5/01	T6C0061R01B5
Parker Denison vane pump 024-03107-5/03	T6C0061R03B5
Parker Denison vane pump 024-03108-0	T6C0051R00B1
Parker Denison vane pump 024-03108-0/01	T6C0051R01B1
Parker Denison vane pump 024-03108-0/02	T6C0051R02B1
Parker Denison vane pump 024-03108-0/03	T6C0051R03B1
Parker Denison vane pump 024-03108-4	T6C0051R00B4
Parker Denison vane pump 024-03108-5	T6C0051R00B5
Parker Denison vane pump 024-03108-5/01	T6C0051R01B5
Parker Denison vane pump 024-03108-5/02	T6C0051R02B5
Parker Denison vane pump 024-03108-5/03	T6C0051R03B5
Parker Denison vane pump 024-03109-0	T6C0101L00B1
Parker Denison vane pump 024-03109-0/01	T6C0101L01B1
Parker Denison vane pump 024-03109-0/02	T6C0101L02B1
Parker Denison vane pump 024-03109-0/03	T6C0101L03B1
Parker Denison vane pump 024-03110-0	T6C0142R00B1
Parker Denison vane pump 024-03110-0	T6C0142R00B1
Parker Denison vane pump 024-03110-0/01	T6C0142R01B1
Parker Denison vane pump 024-03110-0/02	T6C0142R02B1
Parker Denison vane pump 024-03110-0/02	T6C0142R02B1
Parker Denison vane pump 024-03110-0/03	T6C0142R03B1
Parker Denison vane pump 024-03110-0/03	T6C0142R03B1
Parker Denison vane pump 024-03110-4/01	T6C0142R01B4
Parker Denison vane pump 024-03110-5	T6C0142R00B5
Parker Denison vane pump 024-03110-5/01	T6C0142R01B5
Parker Denison vane pump 024-03110-5/02	T6C0142R02B5
Parker Denison vane pump 024-03110-5/03	T6C0142R03B5
Parker Denison vane pump 024-03111-0	T6C0083R00B1
Parker Denison vane pump 024-03111-0/01	T6C0083R01B1
Parker Denison vane pump 024-03111-0/02	T6C0083R02B1
Parker Denison vane pump 024-03111-0/03	T6C0083R03B1
Parker Denison vane pump 024-03111-5	T6C0083R00B5
Parker Denison vane pump 024-03112-0	T6C0102R00B1
Parker Denison vane pump 024-03112-0/02	T6C0102R02B1
Parker Denison vane pump 024-03112-0/02	T6C0102R02B1
Parker Denison vane pump 024-03112-0/03	T6C0102R03B1
Parker Denison vane pump 024-03112-0/03	T6C0102R03B1
Parker Denison vane pump 024-03112-5	T6C0102R00B5
Parker Denison vane pump 024-03112-5/02	T6C0102R02B5
Parker Denison vane pump 024-03113-0	T6C0171L00B1
Parker Denison vane pump 024-03113-0/01	T6C0171L01B1
Parker Denison vane pump 024-03113-0/02	T6C0171L02B1
Parker Denison vane pump 024-03113-0/03	T6C0171L03B1
Parker Denison vane pump 024-03113-5	T6C0171L00B5
Parker Denison vane pump 024-03114-0	T6C0172L00B1
Parker Denison vane pump 024-03114-0/01	T6C0172L01B1
Parker Denison vane pump 024-03114-0/02	T6C0172L02B1
Parker Denison vane pump 024-03114-0/03	T6C0172L03B1
Parker Denison vane pump 024-03114-5	T6C0172L00B5
Parker Denison vane pump 024-03115-0	T6C0223L00B1
Parker Denison vane pump 024-03115-0/01	T6C0223L01B1
Parker Denison vane pump 024-03115-0/02	T6C0223L02B1
Parker Denison vane pump 024-03115-0/03	T6C0223L03B1
Parker Denison vane pump 024-03115-5	T6C0223L00B5
Parker Denison vane pump 024-03116-0	T6C0141L00B1
Parker Denison vane pump 024-03116-0/01	T6C0141L01B1
Parker Denison vane pump 024-03116-0/02	T6C0141L02B1
Parker Denison vane pump 024-03116-0/03	T6C0141L03B1
Parker Denison vane pump 024-03116-0/03	T6C0141L03B1
Parker Denison vane pump 024-03116-5	T6C0141L00B5
Parker Denison vane pump 024-03116-5/01	T6C0141L01B5
Parker Denison vane pump 024-03116-5/02	T6C0141L02B5
Parker Denison vane pump 024-03116-5/03	T6C0141L03B5
Parker Denison vane pump 024-03117-0	T6C0253L00B1
Parker Denison vane pump 024-03117-0/03	T6C0253L03B1
Parker Denison vane pump 024-03117-5	T6C0253L00B5
Parker Denison vane pump 024-03118-0	T6C0143R00B1
Parker Denison vane pump 024-03118-0/01	T6C0143R01B1
Parker Denison vane pump 024-03118-0/02	T6C0143R02B1
Parker Denison vane pump 024-03118-0/03	T6C0143R03B1
Parker Denison vane pump 024-03119-0	T6C0082L00B1
Parker Denison vane pump 024-03119-0/01	T6C0082L01B1
Parker Denison vane pump 024-03119-0/02	T6C0082L02B1
Parker Denison vane pump 024-03119-0/03	T6C0082L03B1
Parker Denison vane pump 024-03119-5	T6C0082L00B5
Parker Denison vane pump 024-03119-5/01	T6C0082L01B5

Parker Denison vane pump 014-97757-0	T6C0173L00B1
Parker Denison vane pump 014-97757-0/01	T6C0173L01B1
Parker Denison vane pump 014-97757-5	T6C0173L00B5
Parker Denison vane pump 014-97764-0	T6C0083L00B1
Parker Denison vane pump 014-97764-5	T6C0083L00B5
Parker Denison vane pump 014-97797-0	T6C0103R00C1
Parker Denison vane pump 014-97797-0	T6C0103R00B1
Parker Denison vane pump 014-97797-0/01	T6C0103R01B1
Parker Denison vane pump 014-97797-0/02	T6C0103R02B1
Parker Denison vane pump 014-97797-0/03	T6C0103R03B1
Parker Denison vane pump 014-97797-0/03	T6C0103R03B1
Parker Denison vane pump 014-97798-0	T6C0103L00B1
Parker Denison vane pump 014-97798-0/01	T6C0103L01B1
Parker Denison vane pump 014-97798-0/02	T6C0103L02B1
Parker Denison vane pump 014-97798-0/03	T6C0103L03B1
Parker Denison vane pump 014-97798-5	T6C0103L00B5
Parker Denison vane pump 014-97806-0	T6C0033L00B1
Parker Denison vane pump 014-97806-0/01	T6C0033L01B1
Parker Denison vane pump 014-97831-0	T6C0102L00B1
Parker Denison vane pump 014-97831-0/02	T6C0102L02B1
Parker Denison vane pump 014-97831-0/03	T6C0102L03B1
Parker Denison vane pump 014-97831-4	T6C0102L00B4
Parker Denison vane pump 024-02792-0	T6C0283L01B1M
Parker Denison vane pump 024-02792-6/01	T6C0283L01B6M
Parker Denison vane pump 024-03088-0	T6C0221R00B1
Parker Denison vane pump 024-03088-0	T6C0221R00B1
Parker Denison vane pump 024-03088-0/01	T6C0221R01B1
Parker Denison vane pump 024-03088-0/02	T6C0221R02B1
Parker Denison vane pump 024-03088-0/03	T6C0221R03B1
Parker Denison vane pump 024-03088-4/03	T6C0221R03B4
Parker Denison vane pump 024-03088-5	T6C0221R00B5
Parker Denison vane pump 024-03088-5/01	T6C0221R01B5
Parker Denison vane pump 024-03088-5/02	T6C0221R02B5
Parker Denison vane pump 024-03088-5/03	T6C0221R03B5
Parker Denison vane pump 024-03375-0	T6C0061L00B1
Parker Denison vane pump 024-03375-0/01	T6C0061L01B1
Parker Denison vane pump 024-03379-0	T6C0142L00B1
Parker Denison vane pump 024-03379-0/01	T6C0142L01B1
Parker Denison vane pump 024-03379-0/03	T6C0142L03B1
Parker Denison vane pump 024-03398-0	T6C0031R00B1
Parker Denison vane pump 024-03398-0	T6C0031R00B1
Parker Denison vane pump 024-03398-0/01	T6C0031R01B1
Parker Denison vane pump 024-03398-0/02	T6C0031R02B1
Parker Denison vane pump 024-03398-0/03	T6C0031R03B1
Parker Denison vane pump 024-03398-4	T6C0031R00B4
Parker Denison vane pump 024-03398-5	T6C0031R00B5
Parker Denison vane pump 024-03398-5/03	T6C0031R03B5
Parker Denison vane pump 024-03399-0	T6C0172R00B1
Parker Denison vane pump 024-03399-0	T6C0172R00B1
Parker Denison vane pump 024-03399-0/01	T6C0172R01B1
Parker Denison vane pump 024-03399-0/01	T6C0172R01B1
Parker Denison vane pump 024-03399-0/02	T6C0172R02B1
Parker Denison vane pump 024-03399-0/03	T6C0172R03B1
Parker Denison vane pump 024-03399-5	T6C0172R00B5
Parker Denison vane pump 024-03399-5/01	T6C0172R01B5
Parker Denison vane pump 024-03400-0	T6C0173R00B1
Parker Denison vane pump 024-03400-0/01	T6C0173R01B1
Parker Denison vane pump 024-03400-0/02	T6C0173R02B1
Parker Denison vane pump 024-03400-0/03	T6C0173R03B1
Parker Denison vane pump 024-03401-0	T6C0222R00B1
Parker Denison vane pump 024-03401-0	T6C0222R00B1
Parker Denison vane pump 024-03401-0/01	T6C0222R01B1
Parker Denison vane pump 024-03401-0/02	T6C0222R02B1
Parker Denison vane pump 024-03401-0/03	T6C0222R03B1
Parker Denison vane pump 024-03401-0/03	T6C0222R03B1
Parker Denison vane pump 024-03401-5	T6C0222R00B5
Parker Denison vane pump 024-03401-5/01	T6C0222R01B5
Parker Denison vane pump 024-03401-5/02	T6C0222R02B5
Parker Denison vane pump 024-03401-5/03	T6C0222R03B5
Parker Denison vane pump 024-03421-0	T6C0174R00B1
Parker Denison vane pump 024-03421-0/03	T6C0174R03B1
Parker Denison vane pump 024-03421-4/03	T6C0174R03B4
Parker Denison vane pump 024-03422-0	T6C0052R00B1
Parker Denison vane pump 024-03422-0/01	T6C0052R01B1
Parker Denison vane pump 024-03422-0/03	T6C0052R03B1
Parker Denison vane pump 024-03484-0	T6C0251L00B1
Parker Denison vane pump 024-03484-0/01	T6C0251L01B1

Parker Denison vane pump 024-03484-0/03	T6C0251L03B1
Parker Denison vane pump 024-03484-5	T6C0251L00B5
Parker Denison vane pump 024-03484-5/03	T6C0251L03B5
Parker Denison vane pump 024-03499-0	T6C0222L00B1
Parker Denison vane pump 024-03499-0/01	T6C0222L01B1
Parker Denison vane pump 024-03499-0/02	T6C0222L02B1
Parker Denison vane pump 024-03499-5	T6C0222L00B5
Parker Denison vane pump 024-03517-0	T6C0143L00B1
Parker Denison vane pump 024-03517-0/01	T6C0143L01B1
Parker Denison vane pump 024-03517-0/02	T6C0143L02B1
Parker Denison vane pump 024-03517-0/03	T6C0143L03B1
Parker Denison vane pump 024-03517-5	T6C0143L00B5
Parker Denison vane pump 024-03527-0	T6C0051L00B1
Parker Denison vane pump 024-03527-0/01	T6C0051L01B1
Parker Denison vane pump 024-03527-4	T6C0051L00B4
Parker Denison vane pump 024-03527-5/03	T6C0051L03B5
Parker Denison vane pump 024-03528-0	T6C0221L00B1
Parker Denison vane pump 024-03528-0/01	T6C0221L01B1
Parker Denison vane pump 024-03529-0	T6C0253R00B1
Parker Denison vane pump 024-03529-0/01	T6C0253R01B1
Parker Denison vane pump 024-03529-0/02	T6C0253R02B1
Parker Denison vane pump 024-03529-0/03	T6C0253R03B1
Parker Denison vane pump 024-03529-4	T6C0253R00B4
Parker Denison vane pump 024-03529-5	T6C0253R00B5
Parker Denison vane pump 024-03600-0	T6C0252R00B1
Parker Denison vane pump 024-03600-0	T6C0252R00B1
Parker Denison vane pump 024-03600-0/01	T6C0252R01B1
Parker Denison vane pump 024-03600-0/02	T6C0252R02B1
Parker Denison vane pump 024-03600-0/02	T6C0252R02B1
Parker Denison vane pump 024-03600-0/03	T6C0252R03B1
Parker Denison vane pump 024-03600-5	T6C0252R00B5
Parker Denison vane pump 024-03611-0	T6C0081L00B1
Parker Denison vane pump 024-03611-0/01	T6C0081L01B1
Parker Denison vane pump 024-03611-0/02	T6C0081L02B1
Parker Denison vane pump 024-03611-0/03	T6C0081L03B1
Parker Denison vane pump 024-03732-0/01	T6C0062R01B1
Parker Denison vane pump 024-03900-0	T6C0063L00B1
Parker Denison vane pump 024-03900-0/01	T6C0063L01B1
Parker Denison vane pump 024-03900-0/02	T6C0063L02B1
Parker Denison vane pump 024-25502-0	T6C0053R00B1
Parker Denison vane pump 024-25502-0/02	T6C0053R02B1
Parker Denison vane pump 024-25502-0/03	T6C0053R03B1
Parker Denison vane pump 024-25502-5/02	T6C0053R02B5
Parker Denison vane pump 024-25517-0	T6C0281L00B1
Parker Denison vane pump 024-25729-0	T6C0031L01A1
Parker Denison vane pump 024-25729-0	T6C0031L00B1
Parker Denison vane pump 024-25729-5	T6C0031L00B5
Parker Denison vane pump 024-25762-0	T6C0063R00B1
Parker Denison vane pump 024-25762-0/01	T6C0063R01B1
Parker Denison vane pump 024-25762-4	T6C0063R00B4
Parker Denison vane pump 024-25809-0	T6C0281R00B1
Parker Denison vane pump 024-25809-0	T6C0281R00B1
Parker Denison vane pump 024-25809-0/02	T6C0281R02B1
Parker Denison vane pump 024-25809-0/03	T6C0281R03B1
Parker Denison vane pump 024-25809-4	T6C0281R00B4
Parker Denison vane pump 024-25809-5	T6C0281R00B5
Parker Denison vane pump 024-25809-5/01	T6C0281R01B5
Parker Denison vane pump 024-25834-0	T6C0252L00B1
Parker Denison vane pump 024-25834-0	T6C0252L00B1
Parker Denison vane pump 024-25834-0/02	T6C0252L02B1
Parker Denison vane pump 024-25834-0/03	T6C0252L03B1
Parker Denison vane pump 024-25968-0	T6C0144L00B1
Parker Denison vane pump 024-26048-0	T6C0032R00B1
Parker Denison vane pump 024-26048-0/02	T6C0032R02B1
Parker Denison vane pump 024-26048-4/01	T6C0032R01B4
Parker Denison vane pump 024-26048-5/02	T6C0032R02B5
Parker Denison vane pump 024-26048-5/03	T6C003-2R03-B5
Parker Denison vane pump 024-26064-0	T6C0283R00B1
Parker Denison vane pump 024-26064-0/01	T6C0283R01B1
Parker Denison vane pump 024-26064-0/03	T6C0283R03B1
Parker Denison vane pump 024-26112-0	T6C0033R00B1
Parker Denison vane pump 024-26112-0/01	T6C0033R01B1
Parker Denison vane pump 024-26112-0/02	T6C0033R02B1
Parker Denison vane pump 024-26112-0/03	T6C0033R03B1
Parker Denison vane pump 024-26203-0	T6C0062R00B1
Parker Denison vane pump 024-26203-0/03	T6C0062R03B1
Parker Denison vane pump 024-26203-5	T6C0062R00B5

Parker Denison vane pump 024-26203-5/03	T6C0062R03B5
Parker Denison vane pump 024-26299-0	T6C0144R00B1
Parker Denison vane pump 024-26299-0/01	T6C0144R01B1
Parker Denison vane pump 024-26299-0/02	T6C0144R02B1
Parker Denison vane pump 024-26299-0/03	T6C0144R03B1
Parker Denison vane pump 024-26380-0	T6C0064L00B1
Parker Denison vane pump 024-26512-0	T6C0174L00B1
Parker Denison vane pump 024-26559-0	T6C0053L00B1
Parker Denison vane pump 024-26559-0/01	T6C0053L01B1
Parker Denison vane pump 024-26559-0/03	T6C0053L03B1
Parker Denison vane pump 024-26559-5	T6C0053L00B5
Parker Denison vane pump 024-26559-5/01	T6C0053L01B5
Parker Denison vane pump 024-26648-0	T6C0121R00B1
Parker Denison vane pump 024-26648-0/01	T6C0121R01B1
Parker Denison vane pump 024-26648-0/02	T6C0121R02B1
Parker Denison vane pump 024-26648-0/03	T6C0121R03B1
Parker Denison vane pump 024-26648-4	T6C0121R00B4
Parker Denison vane pump 024-26648-4/02	T6C0121R02B4
Parker Denison vane pump 024-26648-5/01	T6C0121R01B5
Parker Denison vane pump 024-26674-0	T6C0224R00B1
Parker Denison vane pump 024-26674-0/01	T6C0224R01B1
Parker Denison vane pump 024-26674-0/02	T6C0224R02B1
Parker Denison vane pump 024-26801-0	T6C0122R00B1
Parker Denison vane pump 024-26801-0/02	T6C0122R02B1
Parker Denison vane pump 024-26801-0/03	T6C0122R03B1
Parker Denison vane pump 024-26801-5	T6C0122R00B5
Parker Denison vane pump 024-26801-5/03	T6C0122R03B5
Parker Denison vane pump 024-268010-4	T6C0122R00B4
Parker Denison vane pump 024-26861-0	T6C0202R00B1
Parker Denison vane pump 024-26861-0	T6C0202R00B1
Parker Denison vane pump 024-26861-0/01	T6C0202R01B1
Parker Denison vane pump 024-26861-5	T6C0202R00B5
Parker Denison vane pump 024-26875-0	T6C0052L00B1
Parker Denison vane pump 024-26875-0/01	T6C0052L01B1
Parker Denison vane pump 024-26879-0	T6C0034R00B1
Parker Denison vane pump 024-26897-0	T6C0032L00B1
Parker Denison vane pump 024-26898-0	T6C0062L00B1
Parker Denison vane pump 024-26898-5/01	T6C0062L01B5
Parker Denison vane pump 024-26923-0	T6C0282R00B1
Parker Denison vane pump 024-26923-0/03	T6C0282R03B1
Parker Denison vane pump 024-31002-0	T6C0123R00B1
Parker Denison vane pump 024-31002-0/02	T6C0123R02B1
Parker Denison vane pump 024-31054-0	T6C0104R00B1
Parker Denison vane pump 024-31054-0/01	T6C0104R01B1
Parker Denison vane pump 024-31054-0/02	T6C0104R02B1
Parker Denison vane pump 024-31055-0	T6C0104L00B1
Parker Denison vane pump 024-31055-0/01	T6C0104L01B1
Parker Denison vane pump 024-31055-5/01	T6C0104L01B5
Parker Denison vane pump 024-31715-0	T6C0282L00B1
Parker Denison vane pump 024-33254-0	T6C0283L00B1
Parker Denison vane pump 024-33254-0/01	T6C0283L01B1
Parker Denison vane pump 024-33254-4	T6C0283L00B4
Parker Denison vane pump 024-33424-0	T6C0122L00B1
Parker Denison vane pump 024-33424-0/02	T6C0122L02B1
Parker Denison vane pump 024-33424-0/03	T6C0122L03B1
Parker Denison vane pump 024-33786-0	T6C0254R00B1
Parker Denison vane pump 024-33833-0	T6C0121L00B1
Parker Denison vane pump 024-33833-0/03	T6C0121L03B1
Parker Denison vane pump 024-33833-5/01	T6C0121L01B5
Parker Denison vane pump 024-40044-0	T6C0203R00B1
Parker Denison vane pump 024-40044-0/03	T6C0203R03B1
Parker Denison vane pump 024-40396-0	T6C0201R00B1
Parker Denison vane pump 024-40396-0/01	T6C0201R01B1
Parker Denison vane pump 024-40396-0/02	T6C0201R02B1
Parker Denison vane pump 024-40396-0/03	T6C0201R03B1
Parker Denison vane pump 024-40396-5	T6C0201R00B5
Parker Denison vane pump 024-40396-5/01	T6C0201R01B5
Parker Denison vane pump 024-40557-0	T6C0123L00B1
Parker Denison vane pump 024-44061-0	T6C0202L00B1
Parker Denison vane pump 024-44602-4/03	T6C0221R03B4
Parker Denison vane pump 024-44976-0	T6C0103R00B1
Parker Denison vane pump 024-44976-0/01	T6C0103R01B1
Parker Denison vane pump 024-44976-0/02	T6C0103R02B1
Parker Denison vane pump 024-45254-0	T6C0173R00B1
Parker Denison vane pump 024-45534-0	T6C0254L00B1
Parker Denison vane pump 024-45534-0/02	T6C0254L02B1

Parker Denison vane pump 024-49154-0	T6C0053R00B1
Parker Denison vane pump 024-49154-0/01	T6C0053R01B1
Parker Denison vane pump 024-49154-0/02	T6C0053R02B1
Parker Denison vane pump 024-49371-0	T6C0063R00B1
Parker Denison vane pump 024-49372-0	T6C0143R00B1
Parker Denison vane pump 024-49372-0/02	T6C0143R02B1
Parker Denison vane pump 024-49551-0	T6C0203L00B1
Parker Denison vane pump 024-49551-0/01	T6C0203L01B1
Parker Denison vane pump 024-49999-0	T6C0311R00B1
Parker Denison vane pump 024-49999-0	T6C0311R00B1
Parker Denison vane pump 024-49999-0/01	T6C0311R01B1
Parker Denison vane pump 024-49999-0/03	T6C0311R03B1
Parker Denison vane pump 024-49999-4	T6C0311R00B4
Parker Denison vane pump 024-50030-0	T6C0201L00B1
Parker Denison vane pump 024-51048-0	T6C0313R00B1
Parker Denison vane pump 024-51048-0/01	T6C0313R01B1
Parker Denison vane pump 024-51048-0/03	T6C0313R03B1
Parker Denison vane pump 024-51048-4	T6C0313R00B4
Parker Denison vane pump 024-51048-5	T6C0313R00B5
Parker Denison vane pump 024-51243-0	T6C0313L00B1
Parker Denison vane pump 024-51243-0/01	T6C0313L01B1
Parker Denison vane pump 024-51243-0/03	T6C0313L03B1
Parker Denison vane pump 024-58943-5	T6C0311L00B5
Parker Denison vane pump 024-58943-5/02	T6C0311L02B5
Parker Denison vane pump 024-59622-0/03	T6C0221R03B1
Parker Denison vane pump 024-59622-5/02	T6C0221R02B5
Parker Denison vane pump 024-59622-5/03	T6C0221R03B5
Parker Denison vane pump 024-59623-5/03	T6C0051R03B5
Parker Denison vane pump 024-63286-0	T6C0312R00B1
Parker Denison vane pump 024-63286-0	T6C0312R00B1
Parker Denison vane pump 024-63286-0/03	T6C0312R03B1
Parker Denison vane pump 024-63286-4	T6C0312R00B4
Parker Denison vane pump 024-73408-0	T6C0204L00B1
Parker Denison vane pump 024-73408-0/01	T6C0204L01B1
Parker Denison vane pump 024-03120-0	T6D0451R00B1
Parker Denison vane pump 024-03120-0	T6D0451R00B1
Parker Denison vane pump 024-03120-0/01	T6D0451R01B1
Parker Denison vane pump 024-03120-0/02	T6D0451R02B1
Parker Denison vane pump 024-03120-0/03	T6D0451R03B1
Parker Denison vane pump 024-03120-4	T6D0451R00B4
Parker Denison vane pump 024-03120-5	T6D0451R00B5
Parker Denison vane pump 024-03120-5/03	T6D0451R03B5
Parker Denison vane pump 024-03121-0	T6D0421R00B1
Parker Denison vane pump 024-03121-0/01	T6D0421R01B1
Parker Denison vane pump 024-03121-0/02	T6D0421R02B1
Parker Denison vane pump 024-03121-0/03	T6D0421R03B1
Parker Denison vane pump 024-03121-4	T6D0421R00B4
Parker Denison vane pump 024-03121-5	T6D0421R00B5
Parker Denison vane pump 024-03122-0	T6D0381R00B1
Parker Denison vane pump 024-03122-0	T6D0381R00B1
Parker Denison vane pump 024-03122-0/01	T6D0381R01B1
Parker Denison vane pump 024-03122-0/02	T6D0381R02B1
Parker Denison vane pump 024-03122-0/03	T6D0381R03B1
Parker Denison vane pump 024-03122-4	T6D0381R00B4
Parker Denison vane pump 024-03122-5	T6D0381R00B5
Parker Denison vane pump 024-03122-5/02	T6D0381R02B5
Parker Denison vane pump 024-03122-5/03	T6D0381R03B5
Parker Denison vane pump 024-03123-0	T6D0351R00B1
Parker Denison vane pump 024-03123-0/01	T6D0351R01B1
Parker Denison vane pump 024-03123-0/02	T6D0351R02B1
Parker Denison vane pump 024-03123-4	T6D0351R00B4
Parker Denison vane pump 024-03123-5	T6D0351R00B5
Parker Denison vane pump 024-03123-5/03	T6D0351R03B5
Parker Denison vane pump 024-03124-0	T6D0311R00C1
Parker Denison vane pump 024-03124-0	T6D0311R00B1
Parker Denison vane pump 024-03124-0/01	T6D0311R01B1
Parker Denison vane pump 024-03124-0/02	T6D0311R02B1
Parker Denison vane pump 024-03124-5	T6D0311R00B5
Parker Denison vane pump 024-03124-5/02	T6D0311R02B5
Parker Denison vane pump 024-03124-5/03	T6D0311R03B5
Parker Denison vane pump 024-03125-0	T6D0281R00B1
Parker Denison vane pump 024-03125-0/01	T6D0281R01B1
Parker Denison vane pump 024-03125-0/02	T6D0281R02B1
Parker Denison vane pump 024-03125-0/03	T6D0281R03B1
Parker Denison vane pump 024-03125-4	T6D0281R00B4
Parker Denison vane pump 024-03125-5	T6D0281R00B5
Parker Denison vane pump 024-03125-5/01	T6D0281R01B5

Parker Denison vane pump 024-03125-5/02	T6D0281R02B5
Parker Denison vane pump 024-03125-5/03	T6D0281R03B5
Parker Denison vane pump 024-03126-0	T6D0421L00B1
Parker Denison vane pump 024-03126-4	T6D0421L00B4
Parker Denison vane pump 024-03127-0	T6D0353R00B1
Parker Denison vane pump 024-03127-0	T6D0353R00B1
Parker Denison vane pump 024-03127-0/02	T6D0353R02B1
Parker Denison vane pump 024-03127-0/03	T6D0353R03B1
Parker Denison vane pump 024-03127-5	T6D0353R00B5
Parker Denison vane pump 024-03128-0	T6D0381L00B1
Parker Denison vane pump 024-03128-0/01	T6D0381L01B1
Parker Denison vane pump 024-03128-0/03	T6D0381L03B1
Parker Denison vane pump 024-03128-5	T6D0381L00B5
Parker Denison vane pump 014-70393-0	T6D0381L00B1
Parker Denison vane pump 014-97548-0	T6D0312R00B1
Parker Denison vane pump 014-97548-0/01	T6D0312R01B1
Parker Denison vane pump 014-97549-0	T6D0452R00B1
Parker Denison vane pump 014-97549-0	T6D0452R00B1
Parker Denison vane pump 014-97549-0/02	T6D0452R02B1
Parker Denison vane pump 014-97549-0/03	T6D0452R03B1
Parker Denison vane pump 014-97549-4	T6D0452R00B4
Parker Denison vane pump 014-97549-5	T6D0452R00B5
Parker Denison vane pump 014-97767-0	T6D0383R00B1
Parker Denison vane pump 014-97767-0/01	T6D0383R01B1
Parker Denison vane pump 014-97767-0/02	T6D0383R02B1
Parker Denison vane pump 014-97767-0/03	T6D0383R03B1
Parker Denison vane pump 014-97767-4	T6D0383R00B4
Parker Denison vane pump 014-97767-5	T6D0383R00B5
Parker Denison vane pump 014-97783-0	T6D0243R00B1
Parker Denison vane pump 014-97783-5	T6D0243R00B5
Parker Denison vane pump 014-97849-0	T6D0283L00B1
Parker Denison vane pump 014-97849-0/01	T6D0283L01B1
Parker Denison vane pump 024-03067-0/03	T6D0142L03B1
Parker Denison vane pump 024-03485-0	T6D0451L00B1
Parker Denison vane pump 024-03485-4	T6D0451L00B4
Parker Denison vane pump 024-03530-0	T6D0283R00B1
Parker Denison vane pump 024-03530-0/01	T6D0283R01B1
Parker Denison vane pump 024-03530-0/02	T6D0283R02B1
Parker Denison vane pump 024-03530-0/03	T6D0283R03B1
Parker Denison vane pump 024-03531-0	T6D0352R00B1
Parker Denison vane pump 024-03531-5	T6D0352R00B5
Parker Denison vane pump 024-03532-0	T6D0423R00B1
Parker Denison vane pump 024-03532-4	T6D0423R00B4
Parker Denison vane pump 024-03532-5	T6D0423R00B5
Parker Denison vane pump 024-03542-0	T6D0453L00B1
Parker Denison vane pump 024-03542-0/02	T6D0453L02B1
Parker Denison vane pump 024-03542-4	T6D0453L00B4
Parker Denison vane pump 024-03542-4/01	T6D0453L01B4
Parker Denison vane pump 024-03542-5	T6D0453L00B5
Parker Denison vane pump 024-03543-0	T6D0313R00C1
Parker Denison vane pump 024-03543-0	T6D0313R00B1
Parker Denison vane pump 024-03543-0/01	T6D0313R01B1
Parker Denison vane pump 024-03543-0/02	T6D0313R02B1
Parker Denison vane pump 024-03543-0/03	T6D0313R03B1
Parker Denison vane pump 024-03543-4	T6D0313R00B4
Parker Denison vane pump 024-03543-5	T6D0313R00B5
Parker Denison vane pump 024-03582-0	T6D0281L00B1
Parker Denison vane pump 024-03582-4	T6D0281L00B4
Parker Denison vane pump 024-03582-5	T6D0281L00B5
Parker Denison vane pump 024-03592-0	T6D0351L00B1
Parker Denison vane pump 024-03592-0/03	T6D0351L03B1
Parker Denison vane pump 024-03592-4/01	T6D0351L01B4
Parker Denison vane pump 024-03592-5	T6D0351L00B5
Parker Denison vane pump 024-03612-0	T6D0311L00B1
Parker Denison vane pump 024-03612-5	T6D0311L00B5
Parker Denison vane pump 024-25707-0	T6D0353L00B1
Parker Denison vane pump 024-25707-0/01	T6D0353L01B1
Parker Denison vane pump 024-25707-0/02	T6D0353L02B1
Parker Denison vane pump 024-25707-0/03	T6D0353L03B1
Parker Denison vane pump 024-25707-4	T6D0353L00B4
Parker Denison vane pump 024-25707-5	T6D0353L00B5
Parker Denison vane pump 024-25737-0	T6D0382R00B1
Parker Denison vane pump 024-25737-0	T6D0382R00B1
Parker Denison vane pump 024-25737-0/01	T6D0382R01B1
Parker Denison vane pump 024-25737-0/01	T6D0382R01B1
Parker Denison vane pump 024-25737-0/03	T6D0382R03B1
Parker Denison vane pump 024-25737-4	T6D0382R00B4

Parker Denison vane pump 024-25737-5	T6D0382R00B5
Parker Denison vane pump 024-25737-5/02	T6D0382R02B5
Parker Denison vane pump 024-25738-0	T6D0422R00B1
Parker Denison vane pump 024-25738-0/01	T6D0422R01B1
Parker Denison vane pump 024-25738-0/02	T6D0422R02B1
Parker Denison vane pump 024-25738-4	T6D0422R00B4
Parker Denison vane pump 024-25738-5/01	T6D0422R01B5
Parker Denison vane pump 024-25792-0	T6D0282R00B1
Parker Denison vane pump 024-25792-0	T6D0282R00B1
Parker Denison vane pump 024-25792-0/02	T6D0282R02B1
Parker Denison vane pump 024-25792-0/03	T6D0282R03B1
Parker Denison vane pump 024-25792-5/03	T6D0282R03B5
Parker Denison vane pump 024-25798-0	T6D0424R00B1
Parker Denison vane pump 024-25846-0	T6D0454R00B1
Parker Denison vane pump 024-25886-0	T6D0453R00B1
Parker Denison vane pump 024-25886-0/01	T6D0453R01B1
Parker Denison vane pump 024-25886-0/02	T6D0453R02B1
Parker Denison vane pump 024-25886-4	T6D0453R00B4
Parker Denison vane pump 024-25886-4/02	T6D0453R02B4
Parker Denison vane pump 024-25886-5	T6D0453R00B5
Parker Denison vane pump 024-25895-0	T6D0241R00B1
Parker Denison vane pump 024-25895-0/02	T6D0241R02B1
Parker Denison vane pump 024-25895-0/03	T6D0241R03B1
Parker Denison vane pump 024-25895-4	T6D0241R00B4
Parker Denison vane pump 024-25895-5	T6D0241R00B5
Parker Denison vane pump 024-25896-0	T6D0243L00B1
Parker Denison vane pump 024-25948-0	T6D0383L00B1
Parker Denison vane pump 024-25948-0/02	T6D0383L02B1
Parker Denison vane pump 024-25948-0/03	T6D0383L03B1
Parker Denison vane pump 024-26041-4/01	T6D0242R01B4
Parker Denison vane pump 024-26041-4/03	T6D0242R03B4
Parker Denison vane pump 024-26092-0	T6D0352L00B1
Parker Denison vane pump 024-26092-0/03	T6D0352L03B1
Parker Denison vane pump 024-26092-5	T6D0352L00B5
Parker Denison vane pump 024-26102-0	T6D0452L00B1
Parker Denison vane pump 024-26102-0	T6D0452L00B1
Parker Denison vane pump 024-26102-0/01	T6D0452L01B1
Parker Denison vane pump 024-26102-5	T6D0452L00B5
Parker Denison vane pump 024-26113-0	T6D0313L00B1
Parker Denison vane pump 024-26113-0/01	T6D0313L01B1
Parker Denison vane pump 024-26113-0/02	T6D0313L02B1
Parker Denison vane pump 024-26113-0/03	T6D0313L03B1
Parker Denison vane pump 024-26122-0	T6D0312L00B1
Parker Denison vane pump 024-26122-0/03	T6D0312L03B1
Parker Denison vane pump 024-26122-5	T6D0312L00B5
Parker Denison vane pump 024-26122-5/03	T6D0312L03B5
Parker Denison vane pump 024-26163-0	T6D0314L00B1
Parker Denison vane pump 024-26177-0	T6D0423L00B1
Parker Denison vane pump 024-26177-0/03	T6D0423L03B1
Parker Denison vane pump 024-26177-4	T6D0423L00B4
Parker Denison vane pump 024-26177-5	T6D0423L00B5
Parker Denison vane pump 024-26213-0	T6D0282L00B1
Parker Denison vane pump 024-26213-4	T6D0282L00B4
Parker Denison vane pump 024-26274-0	T6D0284L00B1
Parker Denison vane pump 024-26322-0	T6D0422L00B1
Parker Denison vane pump 024-26322-0/03	T6D0422L03B1
Parker Denison vane pump 024-26327-0	T6D0241L00B1
Parker Denison vane pump 024-26980-0	T6D0382L00B1
Parker Denison vane pump 024-26980-0/03	T6D0382L03B1
Parker Denison vane pump 024-26980-5/02	T6D0382L02B5
Parker Denison vane pump 024-31019-0	T6D0201R00B1
Parker Denison vane pump 024-40414-0	T6D0203R00B1
Parker Denison vane pump 024-40414-0/03	T6D0203R03B1
Parker Denison vane pump 024-40830-0/03	T6D0242L03B1
Parker Denison vane pump 024-40951-0	T6D0201L00B1
Parker Denison vane pump 024-40951-4	T6D0201L00B4
Parker Denison vane pump 024-44730-0	T6D0501R00B1
Parker Denison vane pump 024-44730-0/02	T6D0501R02B1
Parker Denison vane pump 024-44730-4	T6D0501R00B4
Parker Denison vane pump 024-49998-0	T6D0501L00B1
Parker Denison vane pump 024-51641-0	T6D0141R00B1
Parker Denison vane pump 024-51641-4	T6D0141R00B4
Parker Denison vane pump 024-51641-5/01	T6D0141R01B5
Parker Denison vane pump 024-58949-0	T6D0503R00B1
Parker Denison vane pump 024-58949-0/02	T6D0503R02B1
Parker Denison vane pump 024-63751-0	T6D0502R00B1
Parker Denison vane pump 024-63751-0	T6D0502R00B1

Parker Denison vane pump 024-63751-4	T6D0502R00B4
Parker Denison vane pump 024-64546-0	T6D0503L00B1
Parker Denison vane pump 024-64546-0/03	T6D0503L03B1
Parker Denison vane pump 024-64546-5/02	T6D0503L02B5
Parker Denison vane pump 024-68415-0/01	T6D0141L01B1
Parker Denison vane pump 024-72015-5/01	T6D0502L01B5
Parker Denison vane pump 024-91416-0	T6D0143R00B1
Parker Denison vane pump 024-25515-0	T6CB171R00B1
Parker Denison vane pump 024-25776-0	T6CB031R00B1
Parker Denison vane pump 024-25777-0	T6CB051R00B1
Parker Denison vane pump 024-25777-4	T6CB051R00B4
Parker Denison vane pump 024-25778-0	T6CB061R00B1
Parker Denison vane pump 024-25778-5	T6CB061R00B5
Parker Denison vane pump 024-25779-0	T6CB081R00B1
Parker Denison vane pump 024-25780-0/01	T6CB082R01B1
Parker Denison vane pump 024-25781-0	T6CB101R00B1
Parker Denison vane pump 024-25782-0	T6CB141R00B1
Parker Denison vane pump 024-25782-0/03	T6CB141R03B1
Parker Denison vane pump 024-25783-0	T6CB173R00B1
Parker Denison vane pump 024-25785-0	T6CB221R00B1
Parker Denison vane pump 024-25786-0	T6CB251L00B1
Parker Denison vane pump 024-25786-0/01	T6CB251L01B1
Parker Denison vane pump 024-25787-0	T6CB253R00B1
Parker Denison vane pump 024-25787-0/03	T6CB253R03B1
Parker Denison vane pump 024-25788-0/03	T6CB281R03B1
Parker Denison vane pump 024-25818-0	T6CB031L00B1
Parker Denison vane pump 024-25823-0	T6CB061L00B1
Parker Denison vane pump 024-25823-0/01	T6CB221L01B1
Parker Denison vane pump 024-25824-0	T6CB101L00B1
Parker Denison vane pump 024-25825-0	T6CB141L00B1
Parker Denison vane pump 024-25825-0/01	T6CB141L01B1
Parker Denison vane pump 024-25825-0/02	T6CB141L02B1
Parker Denison vane pump 024-25826-0/01	T6CB173L01B1
Parker Denison vane pump 024-25827-0	T6CB171L00B1
Parker Denison vane pump 024-25829-0	T6CB251R00B1
Parker Denison vane pump 024-26165-0	T6CB102R00B1
Parker Denison vane pump 024-26199-0	T6CB143R00B1
Parker Denison vane pump 024-26200-0	T6CB223R00B1
Parker Denison vane pump 024-26200-0/03	T6CB223R03B1
Parker Denison vane pump 024-26412-0	T6CB103L00B1
Parker Denison vane pump 024-26413-0	T6CB142R00B1
Parker Denison vane pump 024-26413-0/02	T6CB142R02B1
Parker Denison vane pump 024-26413-0/03	T6CB142R03B1
Parker Denison vane pump 024-26414-0	T6CB143L00B1
Parker Denison vane pump 024-26415-0	T6CB222R00B1
Parker Denison vane pump 024-26747-0	T6CB253L00B1
Parker Denison vane pump 024-26747-0/03	T6CB253L03B1
Parker Denison vane pump 024-26804-0	T6CB283L00B1
Parker Denison vane pump 024-26946-0	T6CB223L00B1
Parker Denison vane pump 024-31030-0	T6CB172R00B1
Parker Denison vane pump 024-31030-0/02	T6CB172R02B1
Parker Denison vane pump 024-31173-0	T6CB081L00B1
Parker Denison vane pump 024-31173-0/02	T6CB081L02B1
Parker Denison vane pump 024-31181-0/02	T6CB222L02B1
Parker Denison vane pump 024-31574-0	T6CB033R00B1
Parker Denison vane pump 024-31591-0	T6CB083R00B1
Parker Denison vane pump 024-31607-0	T6CB052R00B1
Parker Denison vane pump 024-31990-0	T6CB283R00B1
Parker Denison vane pump 024-31990-0/03	T6CB283R03B1
Parker Denison vane pump 024-33205-0	T6CB121R00B1
Parker Denison vane pump 024-33350-5	T6CB053L00B5
Parker Denison vane pump 024-40957-0	T6CB123L00B1
Parker Denison vane pump 024-45547-0	T6CB032R00B1
Parker Denison vane pump 024-50114-0	T6CB202R00B1
Parker Denison vane pump 024-50114-0/02	T6CB202R02B1
Parker Denison vane pump 024-50670-0	T6CB311R00B1
Parker Denison vane pump 024-59895-0	T6CB203R00B1
Parker Denison vane pump 024-63294-0/01	T6CB203L01B1
Parker Denison vane pump 024-64369-0/01	T6CB202L01B1
Parker Denison vane pump 024-68065-0/01	T6CB311L01B1
Parker Denison vane pump 024-68513-0/01	T6CB201L01B1
Parker Denison vane pump 024-69280-0	T6CB313R00B1
Parker Denison vane pump 024-69280-0/03	T6CB313R03B1
Parker Denison vane pump 024-90191-0/03	T6CB314R03B1
Parker Denison vane pump 024-26843-0	T6DB281R00B1
Parker Denison vane pump 024-26843-0/03	T6DB281R03B1
Parker Denison vane pump 024-26845-0	T6DB311R00B1

Parker Denison vane pump 024-26924-0	T6DB351R00B1
Parker Denison vane pump 024-26925-0	T6DB421R00B1
Parker Denison vane pump 024-26925-0/02	T6DB421R02B1
Parker Denison vane pump 024-26971-0	T6DB381R00B1
Parker Denison vane pump 024-30056-0	T6DB241R00B1
Parker Denison vane pump 024-31071-0	T6DB451R00B1
Parker Denison vane pump 024-31071-0/03	T6DB451R03B1
Parker Denison vane pump 024-31093-0	T6DB381L00B1
Parker Denison vane pump 024-31093-0/01	T6DB381L01B1
Parker Denison vane pump 024-31094-0	T6DB423R00B1
Parker Denison vane pump 024-31349-0/01	T6DB421L01B1
Parker Denison vane pump 024-31480-0	T6DB353L00B1
Parker Denison vane pump 024-31578-0	T6DB201R00B1
Parker Denison vane pump 024-31796-0	T6DB283L00B1
Parker Denison vane pump 024-31797-0/01	T6DB351L01B1
Parker Denison vane pump 024-33174-0	T6DB313L00B1
Parker Denison vane pump 024-33280-0	T6DB352R00B1
Parker Denison vane pump 024-33493-0/03	T6DB282R03B1
Parker Denison vane pump 024-33743-0	T6DB283R00B1
Parker Denison vane pump 024-33853-0	T6DB383R00B1
Parker Denison vane pump 024-40414-0	T6DB203R00B1
Parker Denison vane pump 024-45061-0/01	T6DB501L01B1
Parker Denison vane pump 024-59386-0	T6DB501R00B1
Parker Denison vane pump 024-63149-0	T6DB502L00B1
Parker Denison vane pump 024-00674-0	T6E0523R00A1
Parker Denison vane pump 024-00674-0/03	T6E0523R03A1
Parker Denison vane pump 024-00777-0	T6E0661R00A1
Parker Denison vane pump 024-00777-0/01	T6E0661R01A1
Parker Denison vane pump 024-00777-0/02	T6E0661R02A1
Parker Denison vane pump 024-00777-0/03	T6E0661R03A1
Parker Denison vane pump 024-00777-4	T6E0661R00A4
Parker Denison vane pump 024-00777-5	T6E0661R00A5
Parker Denison vane pump 024-00777-5/01	T6E0661R01A5
Parker Denison vane pump 024-00777-5/02	T6E0661R02A5
Parker Denison vane pump 024-00778-0	T6E0621R00A1
Parker Denison vane pump 024-00778-0	T6E0621R00A1
Parker Denison vane pump 024-00778-0/01	T6E0621R01A1
Parker Denison vane pump 024-00778-0/02	T6E0621R02A1
Parker Denison vane pump 024-00778-0/03	T6E0621R03A1
Parker Denison vane pump 024-00778-4	T6E0621R00A4
Parker Denison vane pump 024-00778-4/03	T6E0621R03A4
Parker Denison vane pump 024-00778-5	T6E0621R00A5
Parker Denison vane pump 024-00778-5/01	T6E0621R01A5
Parker Denison vane pump 024-00779-0	T6E0521R00A1
Parker Denison vane pump 024-00779-0/01	T6E0521R01A1
Parker Denison vane pump 024-00779-0/02	T6E0521R02A1
Parker Denison vane pump 024-00779-0/03	T6E0521R03A1
Parker Denison vane pump 024-00779-5	T6E0521R00A5
Parker Denison vane pump 024-00779-5/01	T6E0521R01A5
Parker Denison vane pump 024-00779-5/02	T6E0521R02A5
Parker Denison vane pump 024-00780-0	T6E0451R00A1
Parker Denison vane pump 024-00780-0/01	T6E0451R01A1
Parker Denison vane pump 024-00780-0/02	T6E0451R02A1
Parker Denison vane pump 024-00780-0/03	T6E0451R03A1
Parker Denison vane pump 024-00780-4	T6E0451R00A4
Parker Denison vane pump 024-00780-5	T6E0451R00A5
Parker Denison vane pump 024-00964-0	T6E0452R00A1
Parker Denison vane pump 024-00964-0/03	T6E0452R03A1
Parker Denison vane pump 024-00964-4/02	T6E0452R02A4
Parker Denison vane pump 024-00964-5	T6E0452R00A5
Parker Denison vane pump 024-01176-0	T6E0451L00A1
Parker Denison vane pump 024-01176-5	T6E0451L00A5
Parker Denison vane pump 024-01177-0	T6E0621L00A1
Parker Denison vane pump 024-01177-0/01	T6E0621L01A1
Parker Denison vane pump 024-01177-0/02	T6E0621L02A1
Parker Denison vane pump 024-01177-0/03	T6E0621L03A1
Parker Denison vane pump 024-01177-5	T6E0621L00A5
Parker Denison vane pump 024-01221-0	T6E0663R00A1
Parker Denison vane pump 024-01221-0	T6E0663R00A1
Parker Denison vane pump 024-01221-0/02	T6E0663R02A1
Parker Denison vane pump 024-01221-0/03	T6E0663R03A1
Parker Denison vane pump 024-01327-0	T6E0522R00A1
Parker Denison vane pump 024-01327-4	T6E0522R00A4
Parker Denison vane pump 024-01327-5	T6E0522R00A5
Parker Denison vane pump 024-01418-0	T6E0622R00A1
Parker Denison vane pump 024-01418-0/01	T6E0622R01A1
Parker Denison vane pump 024-01418-0/03	T6E0622R03A1

Parker Denison vane pump 024-01418-4	T6E0622R00A4
Parker Denison vane pump 024-01418-4/02	T6E0622R02A4
Parker Denison vane pump 024-01418-5	T6E0622R00A5
Parker Denison vane pump 024-01418-5/01	T6E0622R01A5
Parker Denison vane pump 024-01615-0	T6E0662R00A1
Parker Denison vane pump 024-01615-0	T6E0662R00A1
Parker Denison vane pump 024-01615-0/02	T6E0662R02A1
Parker Denison vane pump 024-01615-5	T6E0662R00A5
Parker Denison vane pump 024-01648-0	T6E0624R00A1
Parker Denison vane pump 024-01648-0/01	T6E0624R01A1
Parker Denison vane pump 024-01649-0	T6E0623R00A1
Parker Denison vane pump 024-01781-0	T6E0523L00A1
Parker Denison vane pump 024-01781-0/01	T6E0523L01A1
Parker Denison vane pump 024-02044-0	T6E0521L00A1
Parker Denison vane pump 024-02044-0/03	T6E0521L03A1
Parker Denison vane pump 024-02044-5/03	T6E0521L03A5
Parker Denison vane pump 024-02060-0	T6E0622L00A1
Parker Denison vane pump 024-02060-5	T6E0622L00A5
Parker Denison vane pump 024-02105-0	T6E0661L00A1
Parker Denison vane pump 024-02105-0/01	T6E0661L01A1
Parker Denison vane pump 024-02105-0/02	T6E0661L02A1
Parker Denison vane pump 024-02105-0/03	T6E0661L03A1
Parker Denison vane pump 024-02105-5	T6E0661L00A5
Parker Denison vane pump 024-02226-0	T6E0453L00A1
Parker Denison vane pump 024-02283-0	T6E0623L00A1
Parker Denison vane pump 024-02283-0/01	T6E0623L01A1
Parker Denison vane pump 024-02283-0/02	T6E0623L02A1
Parker Denison vane pump 024-02283-5	T6E0623L00A5
Parker Denison vane pump 024-02341-0	T6E0524L00A1
Parker Denison vane pump 024-02708-0	T6E0522L00A1
Parker Denison vane pump 024-02708-5	T6E0522L00A5
Parker Denison vane pump 024-02757-0	T6E0664L00A1
Parker Denison vane pump 024-02944-0	T6E0663L00A1
Parker Denison vane pump 024-02944-0/02	T6E0663L02A1
Parker Denison vane pump 024-02944-0/03	T6E0663L03A1
Parker Denison vane pump 024-02944-5/02	T6E0663L02A5
Parker Denison vane pump 024-02996-0	T6E0452L00A1
Parker Denison vane pump 024-03524-0	T6E0453R00A1
Parker Denison vane pump 024-03524-0/01	T6E0453R01A1
Parker Denison vane pump 024-03524-0/03	T6E0453R03A1
Parker Denison vane pump 024-03524-4/02	T6E0453R02A4
Parker Denison vane pump 024-03813-0	T6E0524R00A1
Parker Denison vane pump 024-03813-0/01	T6E0524R01A1
Parker Denison vane pump 024-26007-0	T6E0664R00A1
Parker Denison vane pump 024-26007-0/01	T6E0664R01A1
Parker Denison vane pump 024-26513-0	T6E0662L00A1
Parker Denison vane pump 024-26513-0/03	T6E0662L03A1
Parker Denison vane pump 024-26513-5	T6E0662L00A5
Parker Denison vane pump 024-40909-0	T6E0721R00A1
Parker Denison vane pump 024-40909-0/01	T6E0721R01A1
Parker Denison vane pump 024-40909-0/02	T6E0721R02A1
Parker Denison vane pump 024-40909-0/03	T6E0721R03A1
Parker Denison vane pump 024-40909-4	T6E0721R00A4
Parker Denison vane pump 024-40909-5	T6E0721R00A5
Parker Denison vane pump 024-40909-5/01	T6E0721R01A5
Parker Denison vane pump 024-40993-0	T6E0721L00A1
Parker Denison vane pump 024-40993-4/01	T6E0721L01A4
Parker Denison vane pump 024-44035-0	T6E0723L00A1
Parker Denison vane pump 024-44035-0/03	T6E0723L03A1
Parker Denison vane pump 024-44035-5/02	T6E0723L02A5
Parker Denison vane pump 024-44426-0	T6E0724R00A1
Parker Denison vane pump 024-44495-0	T6E0723R00A1
Parker Denison vane pump 024-44495-0/02	T6E0723R02A1
Parker Denison vane pump 024-44495-0/03	T6E0723R03A1
Parker Denison vane pump 024-44495-5	T6E0723R00A5
Parker Denison vane pump 024-44566-0	T6E0722R00A1
Parker Denison vane pump 024-44566-5/01	T6E0722R01A5
Parker Denison vane pump 024-44947-0	T6E0501R00A1
Parker Denison vane pump 024-44947-0/02	T6E0501R02A1
Parker Denison vane pump 024-49188-0	T6E0503R00A1
Parker Denison vane pump 024-49188-0/02	T6E0503R02A1
Parker Denison vane pump 024-49188-5	T6E0503R00A5
Parker Denison vane pump 024-49329-0	T6E0501L00A1
Parker Denison vane pump 024-51388-0	T6E0503L00A1
Parker Denison vane pump 024-58950-0	T6E0454R00A1
Parker Denison vane pump 024-59238-0	T6E0851L00A1
Parker Denison vane pump 024-59292-0	T6E0851R00A1

Parker Denison vane pump 024-59292-0/02	T6E0851R02A1
Parker Denison vane pump 024-59610-0	T6E0853R00A1
Parker Denison vane pump 024-59946-0	T6E0853L00A1
Parker Denison vane pump 024-63127-0	T6E0502R00A1
Parker Denison vane pump 024-64541-0	T6E0502L00A1
Parker Denison vane pump 024-68612-5	T6E0854R00A5